

A.M.1 Sanit. Infantil/Faldário
Escala: 1:25

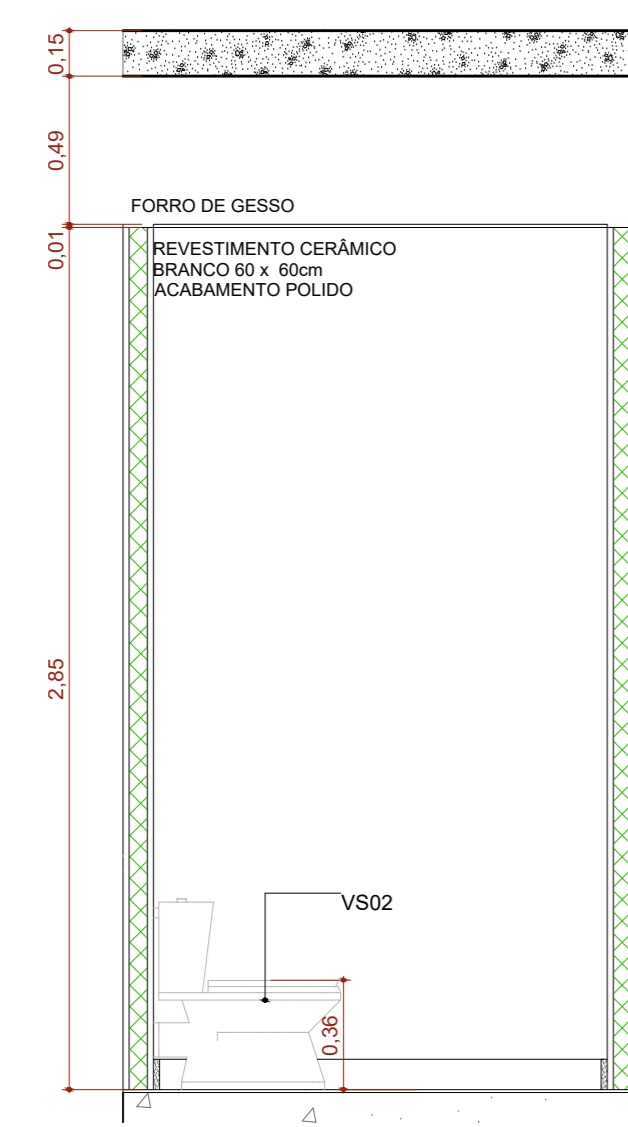

A.M.01 VISTA 1
Escala: 1:25

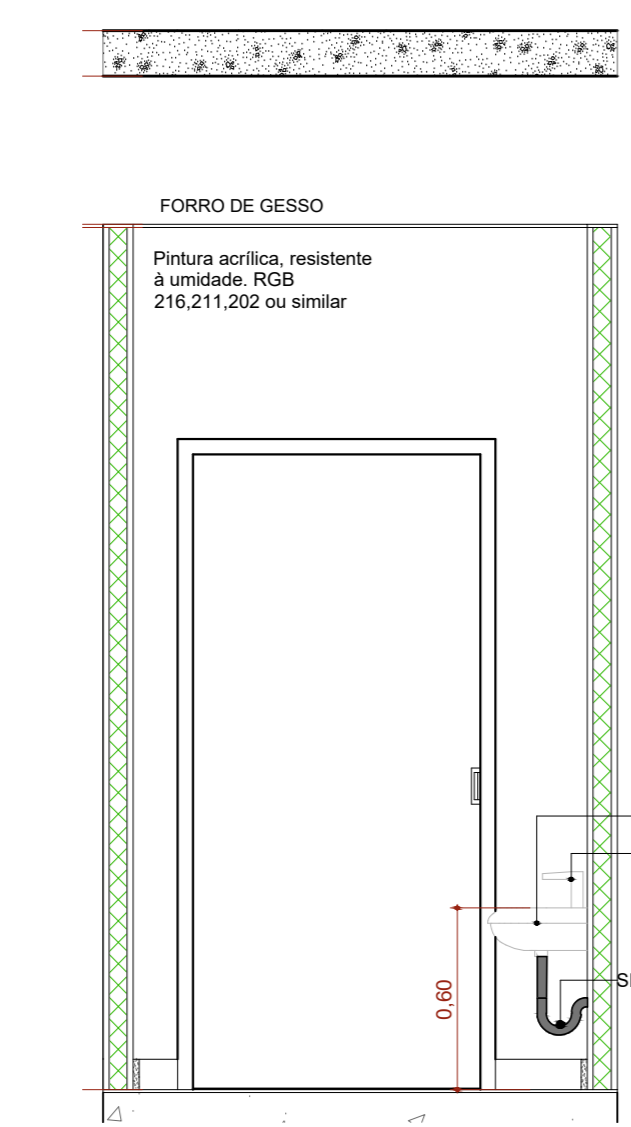

A.M.01 VISTA 2
Escala: 1:25

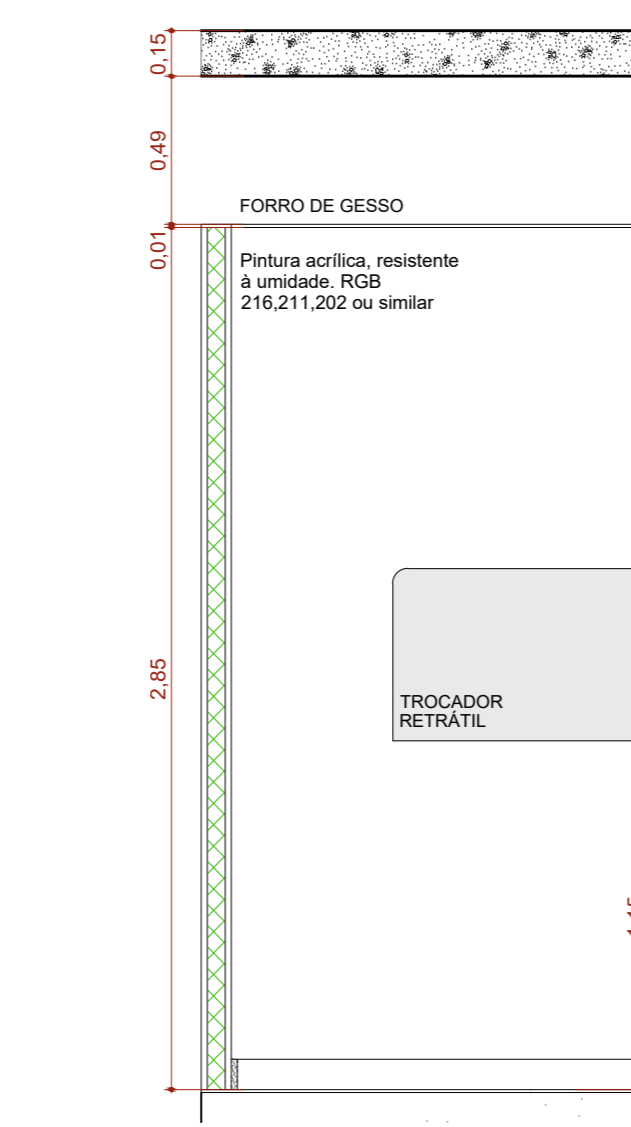

A.M.01 VISTA 3
Escala: 1:25

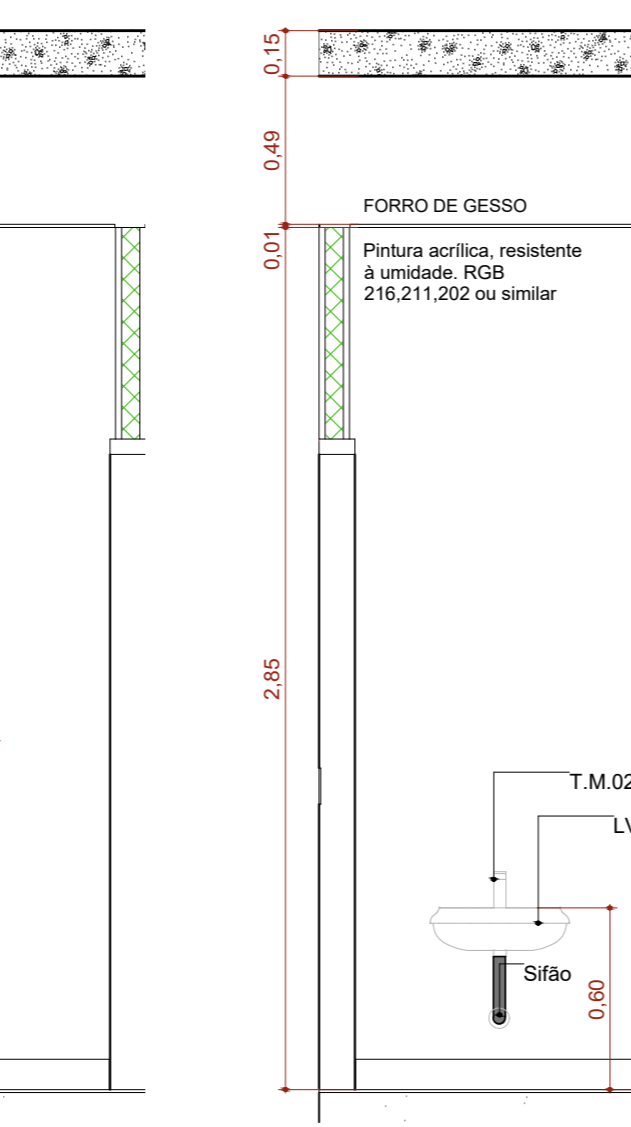

A.M.01 VISTA 4
Escala: 1:25

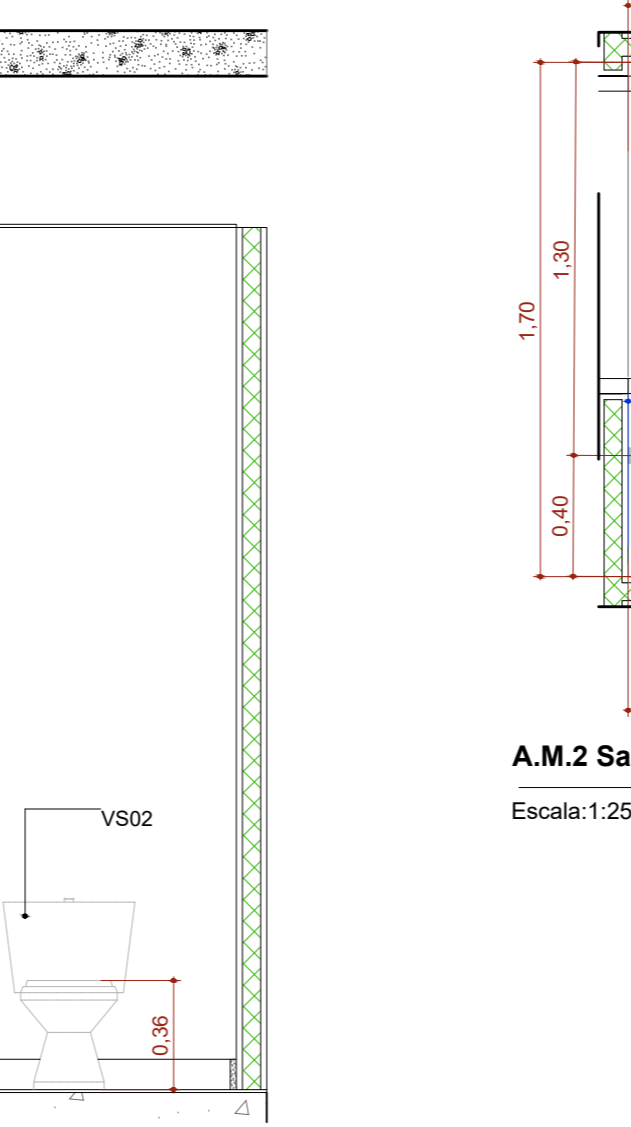

A.M.02 VISTA 1
Escala: 1:25

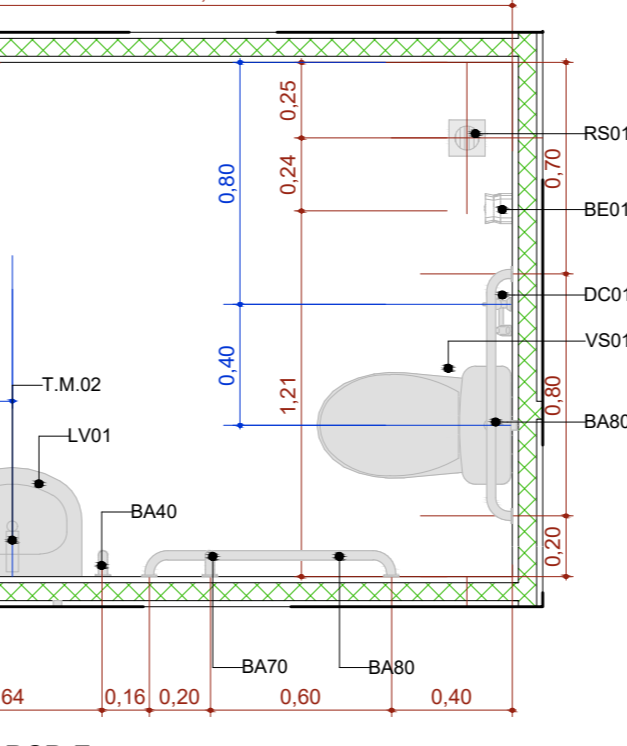

A.M.2 Sanitário PCD Fem.
Escala: 1:25

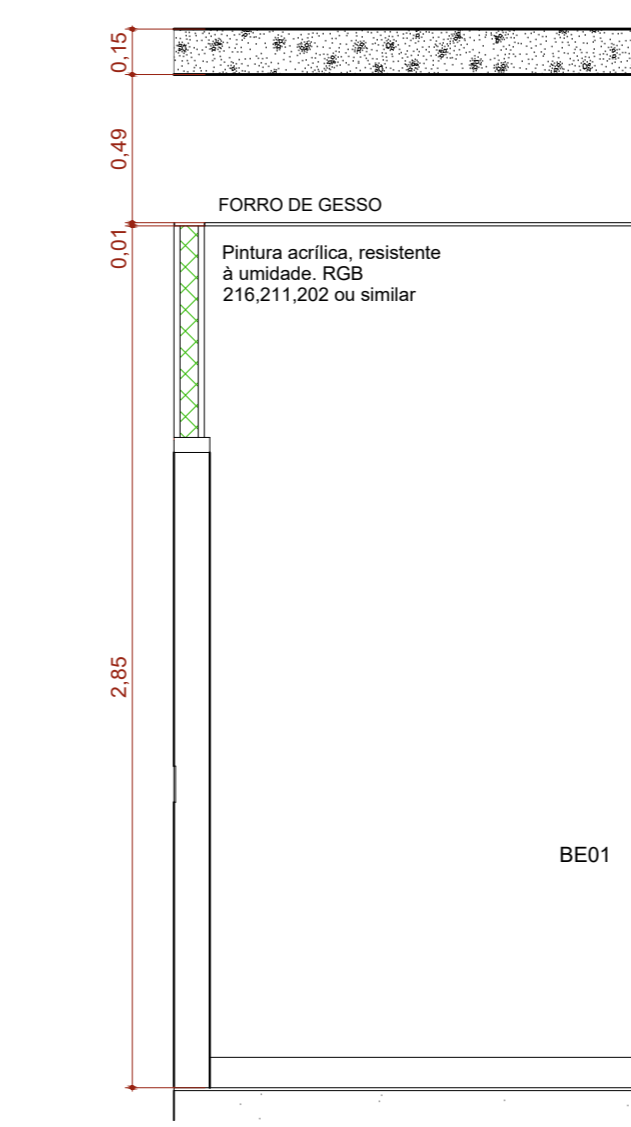

A.M.02 VISTA 2
Escala: 1:25

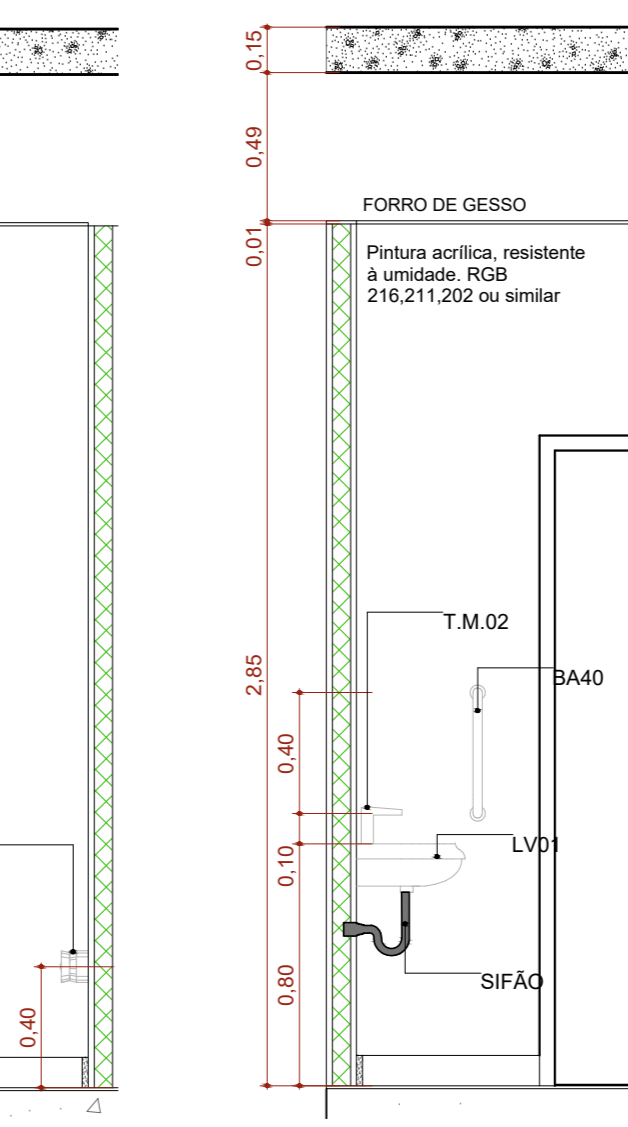

A.M.02 VISTA 3
Escala: 1:25

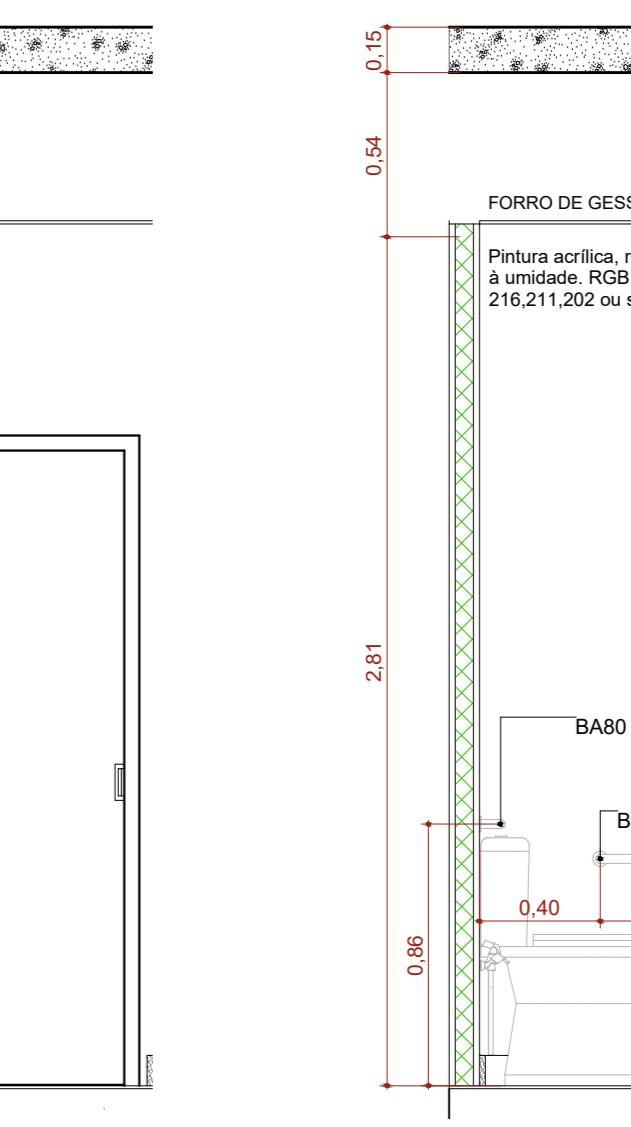

A.M.02 VISTA 4
Escala: 1:25

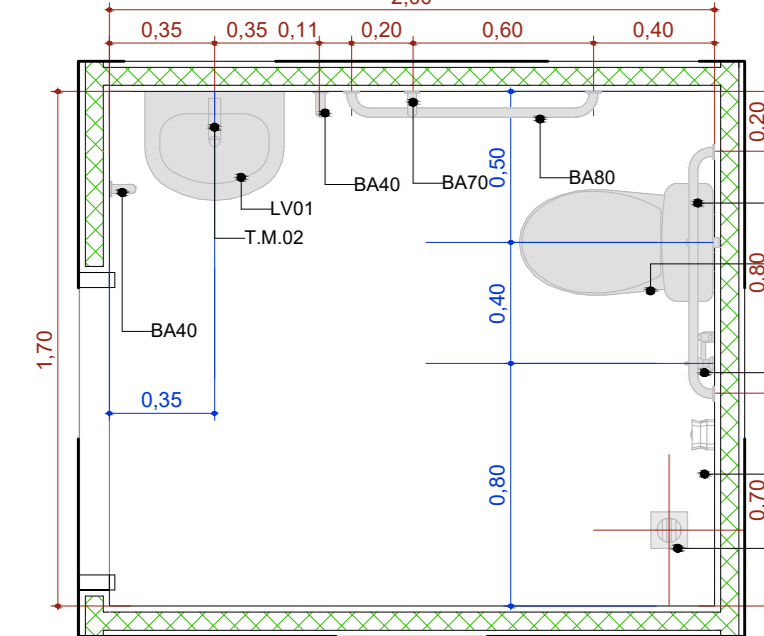

A.M.3 Sanitário PCD Masc.
Escala: 1:25

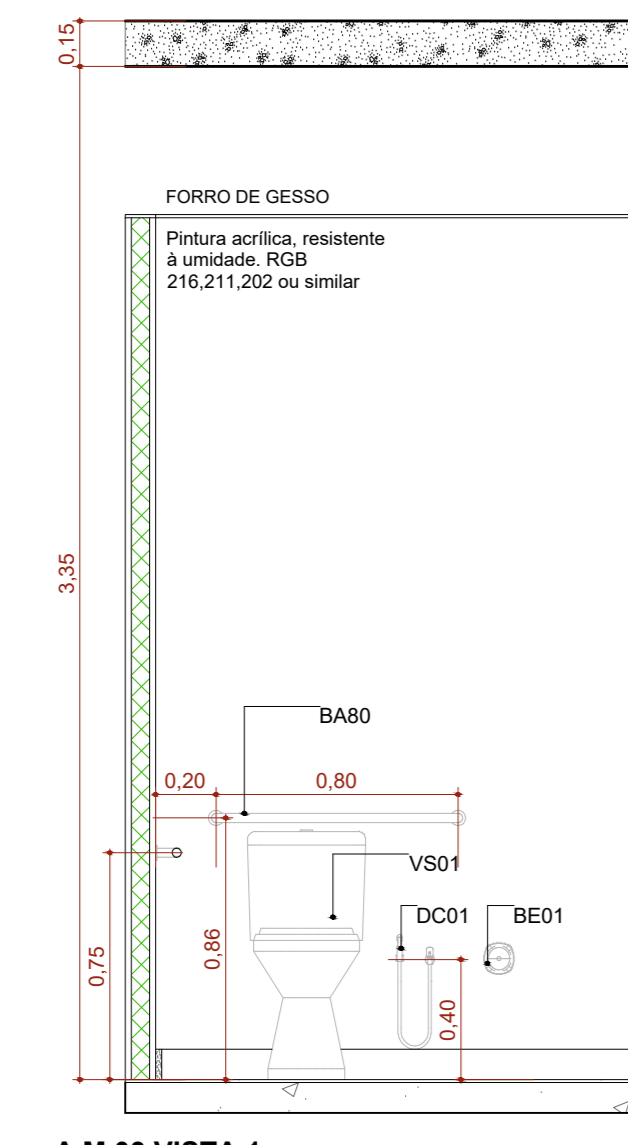

A.M.03 VISTA 1
Escala: 1:25

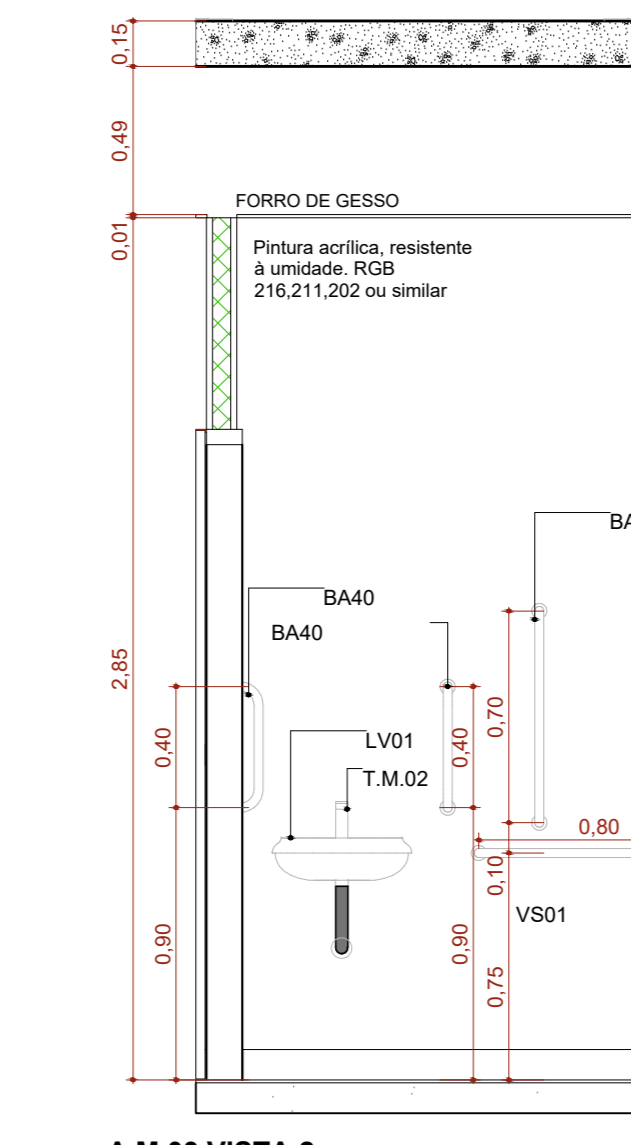

A.M.03 VISTA 2
Escala: 1:25

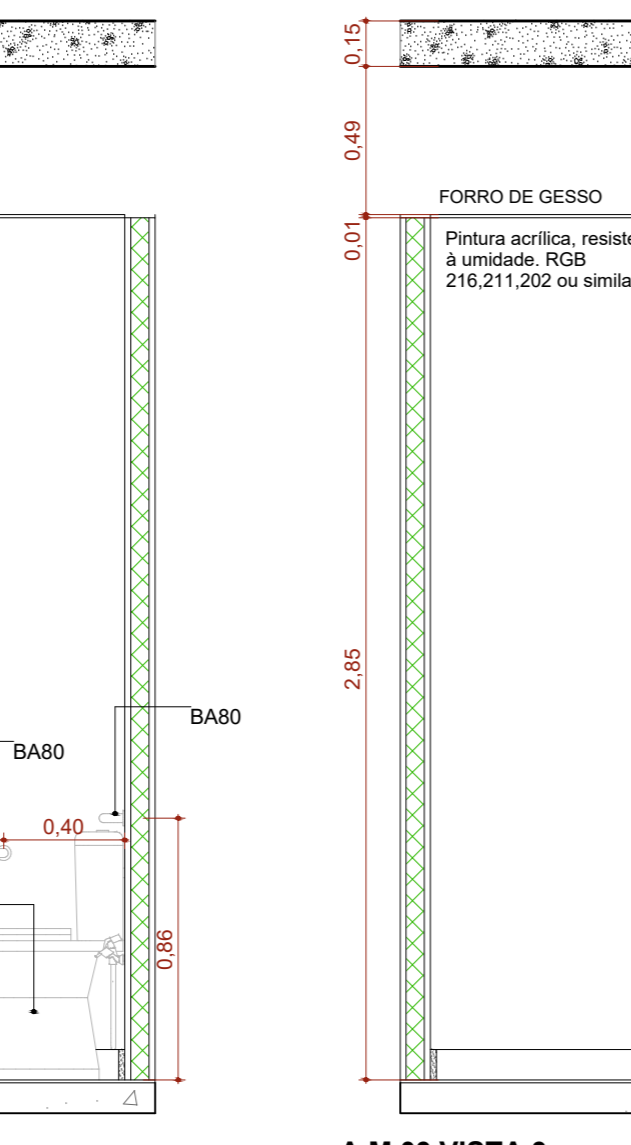

A.M.03 VISTA 3
Escala: 1:25

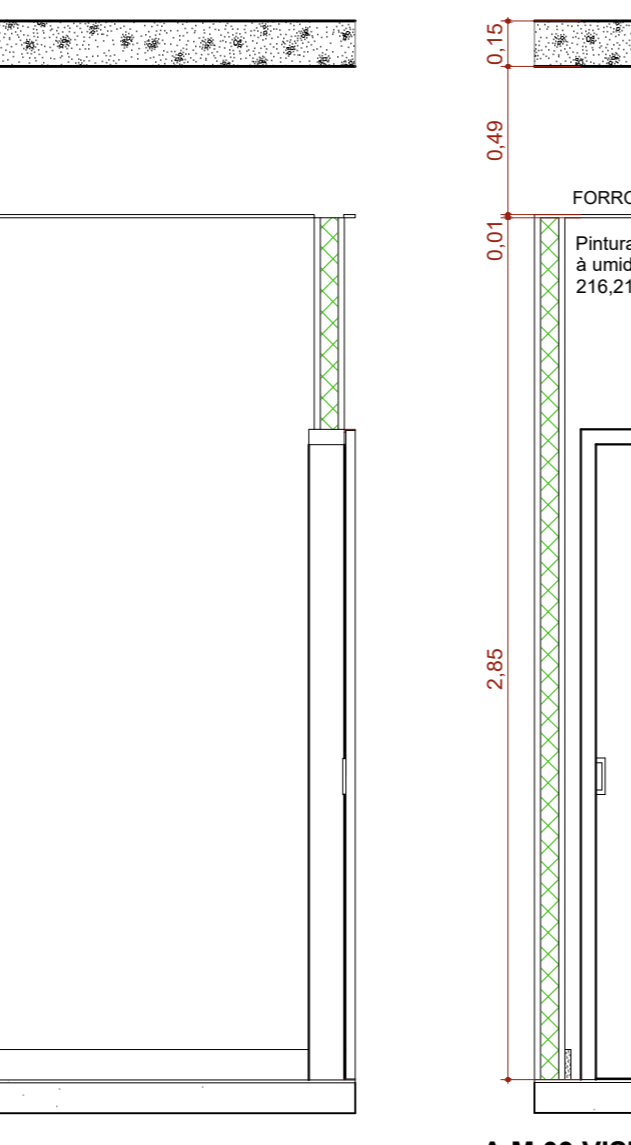

A.M.03 VISTA 4
Escala: 1:25

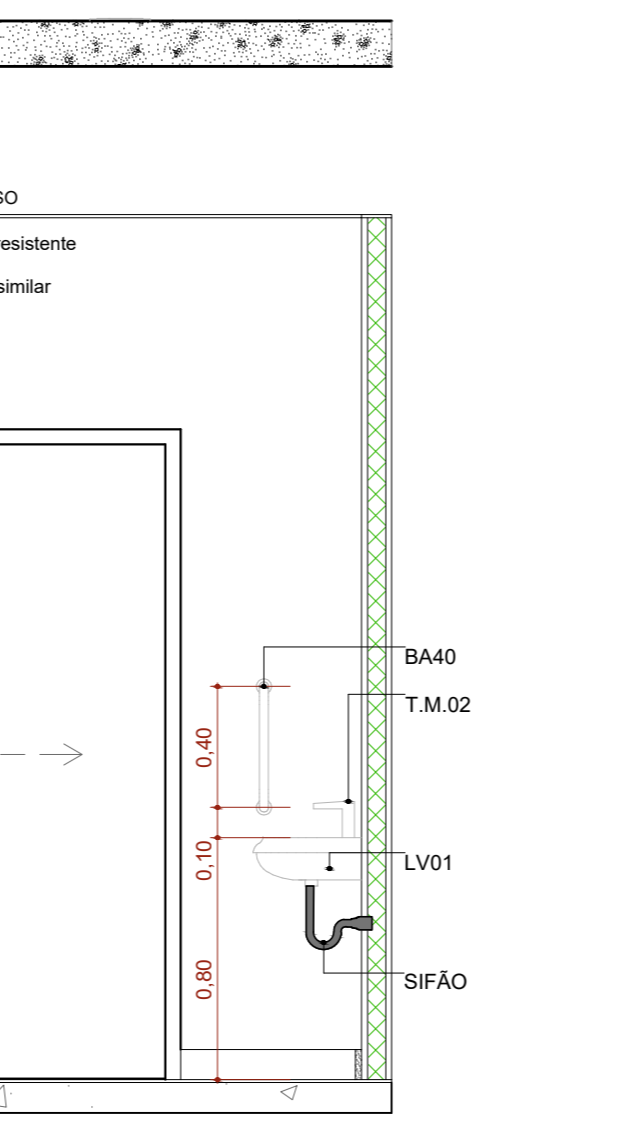

A.M.04 VISTA 1
Escala: 1:25

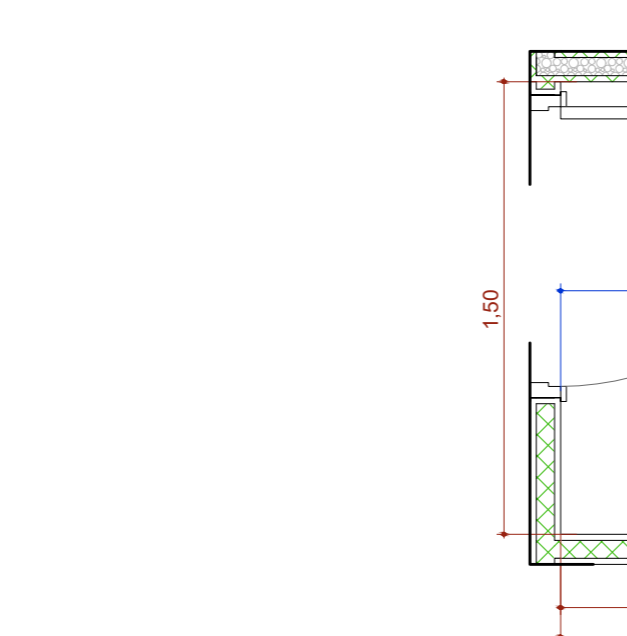

A.M.4 Educação em Saúde Bucal (Escovário)
Escala: 1:25

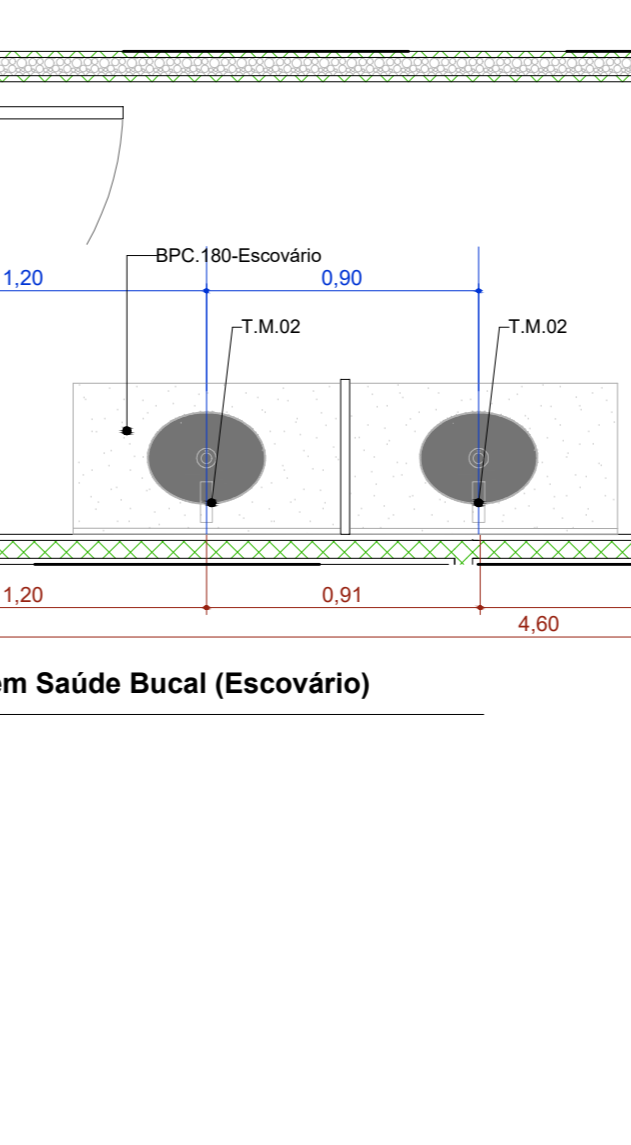

A.M.04 VISTA 2
Escala: 1:25

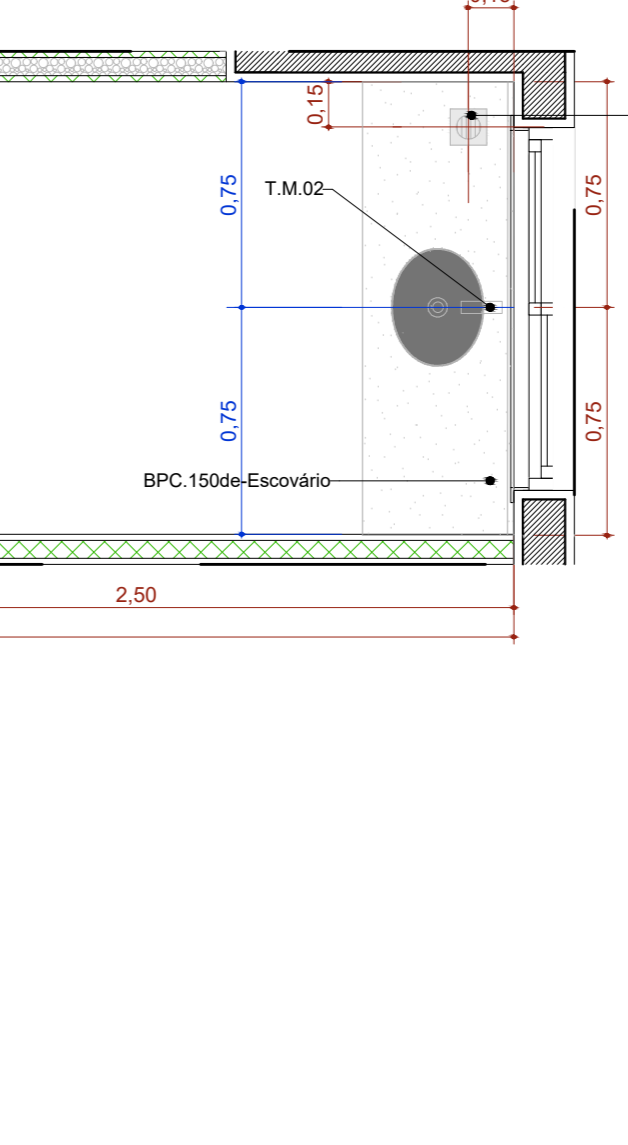

A.M.04 VISTA 3
Escala: 1:25

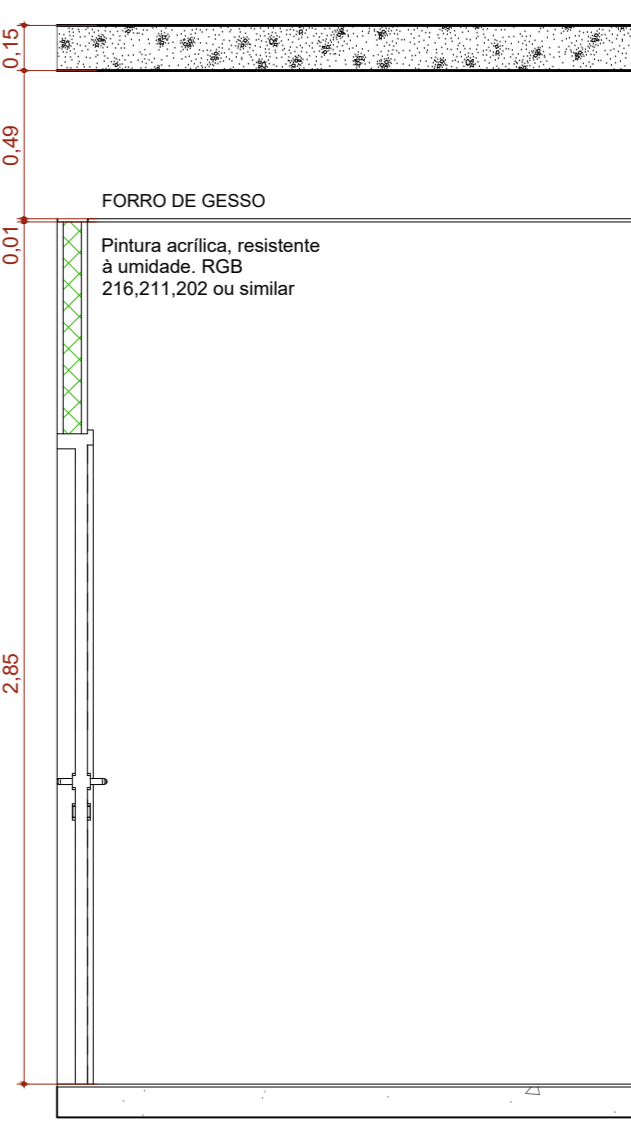

A.M.04 VISTA 4
Escala: 1:25

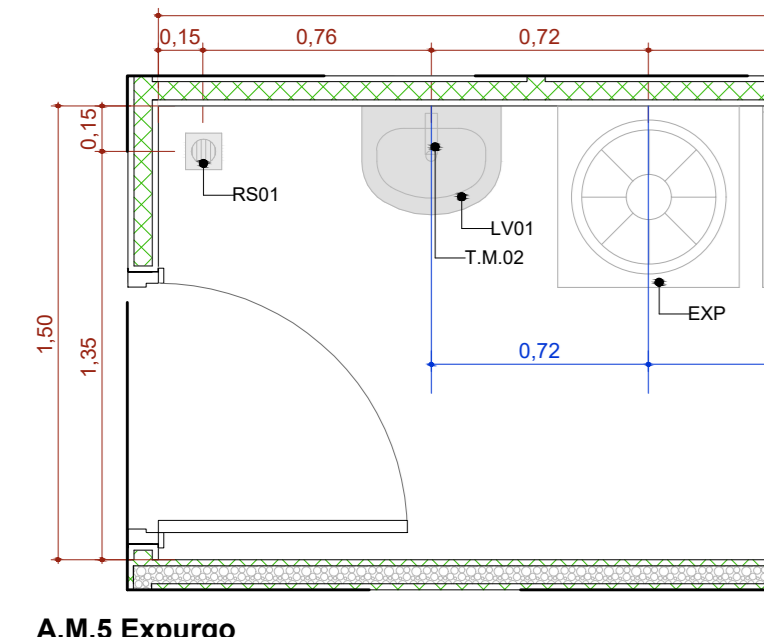

A.M.5 Expurgo
Escala: 1:25

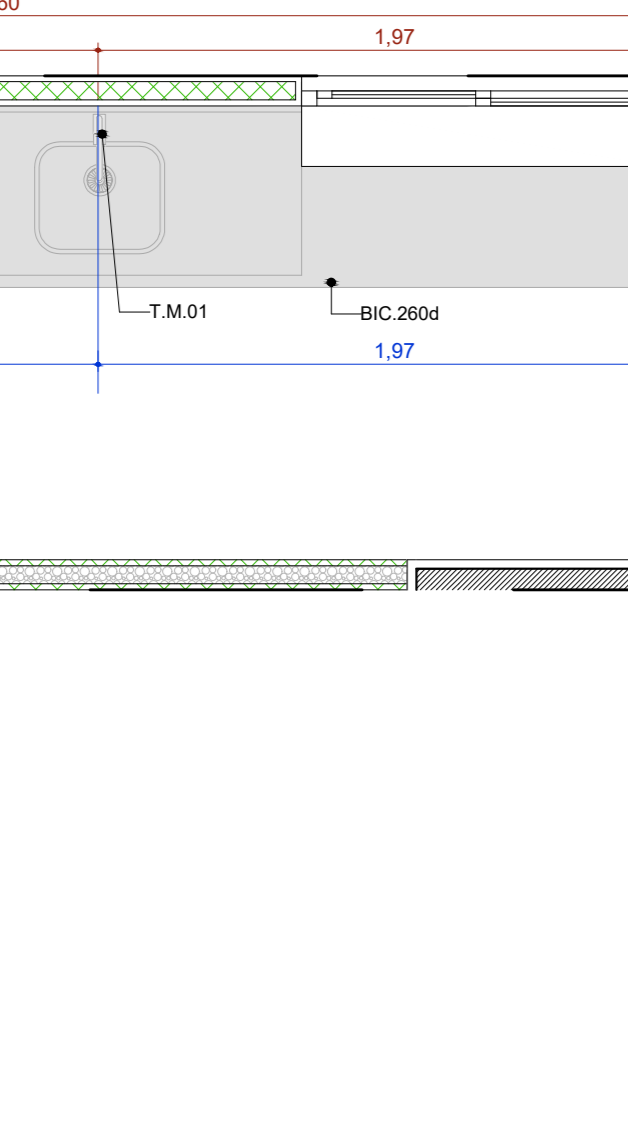

A.M.05 VISTA 1
Escala: 1:25

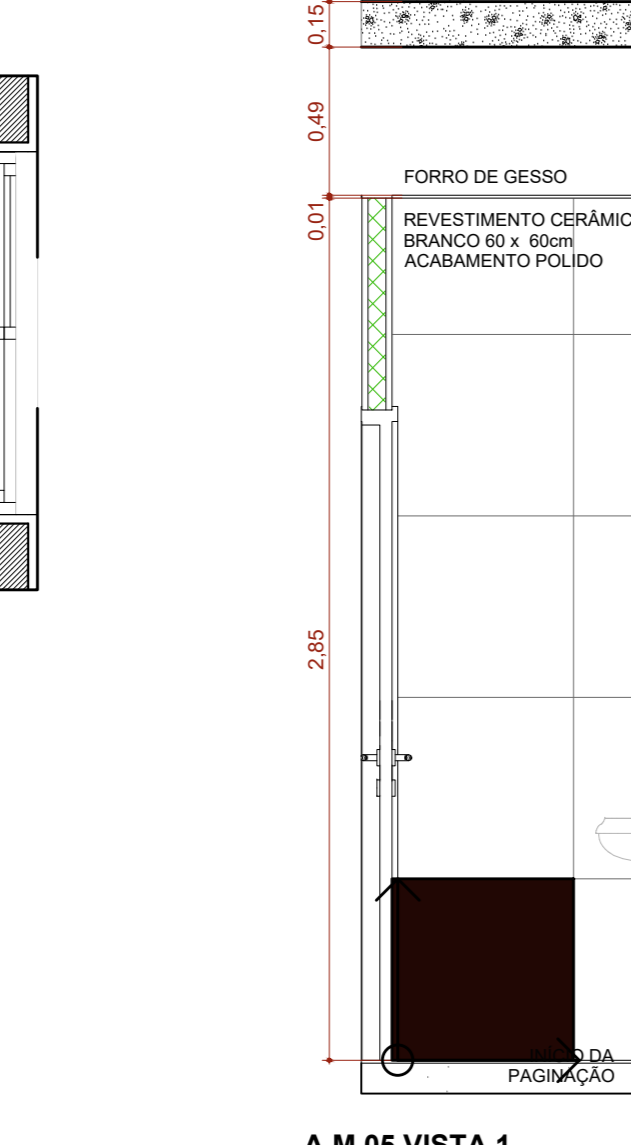

A.M.05 VISTA 2
Escala: 1:25

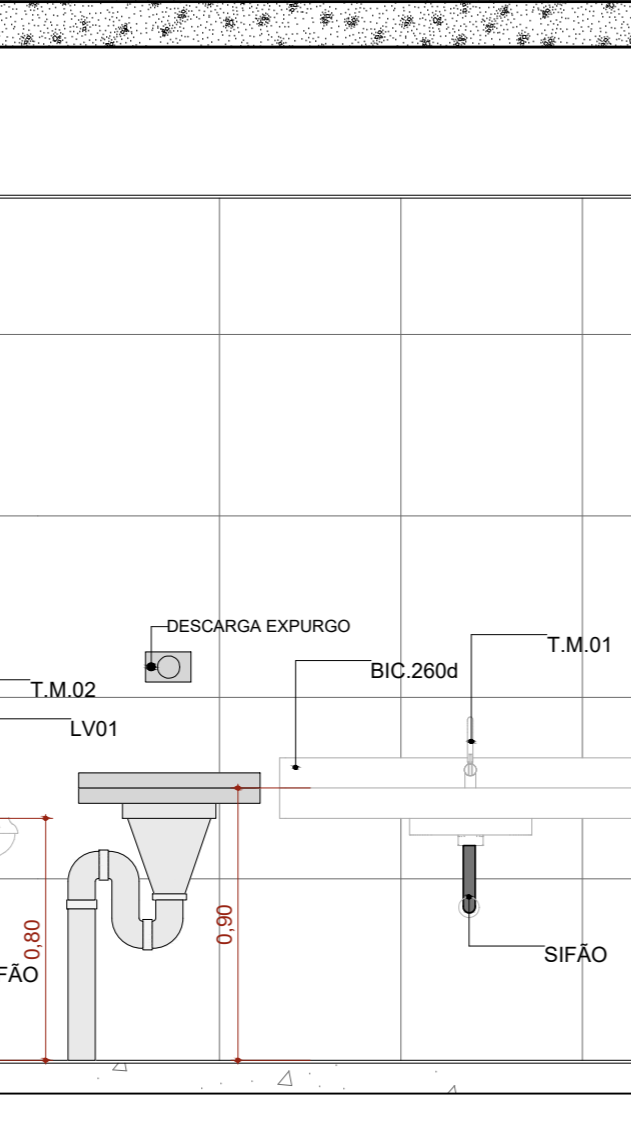

A.M.05 VISTA 3
Escala: 1:25

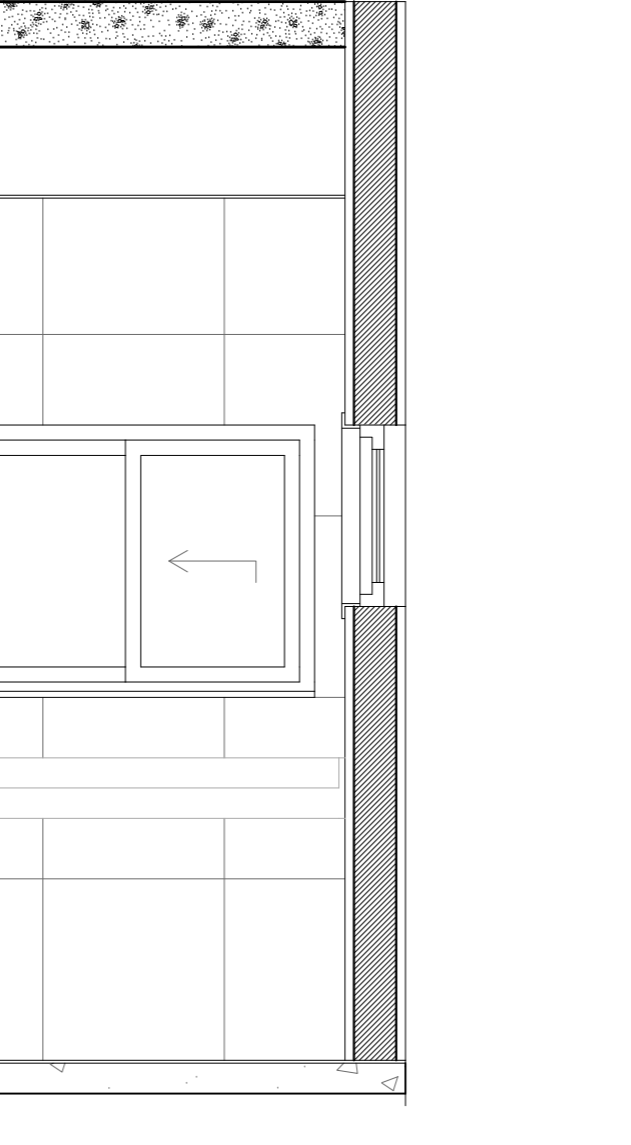

A.M.05 VISTA 4
Escala: 1:25

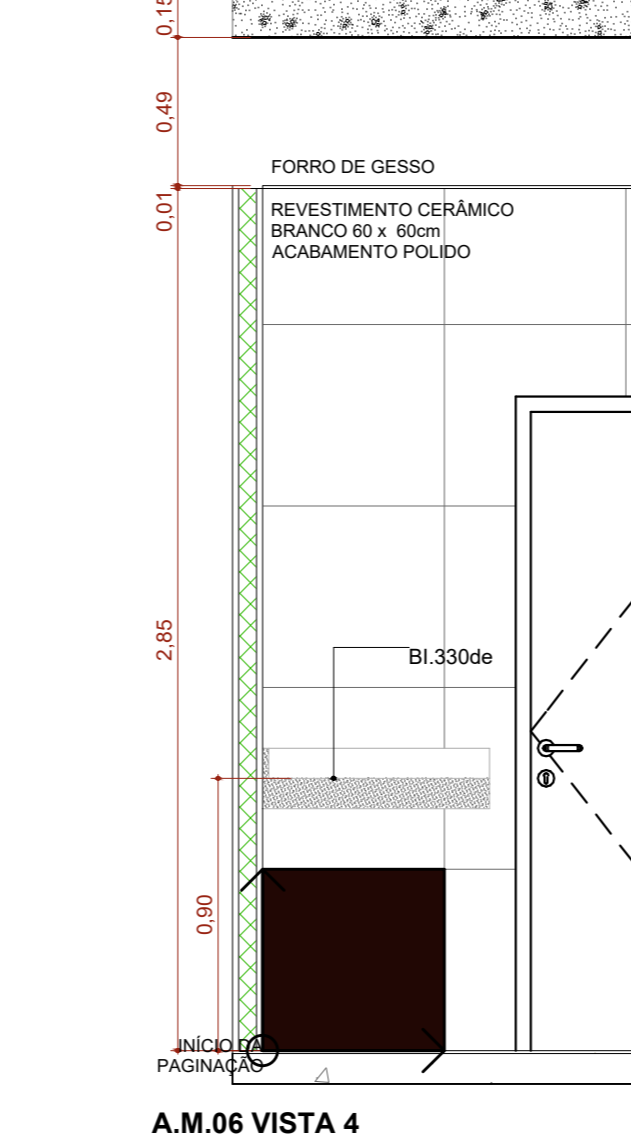

A.M.06 VISTA 1
Escala: 1:25

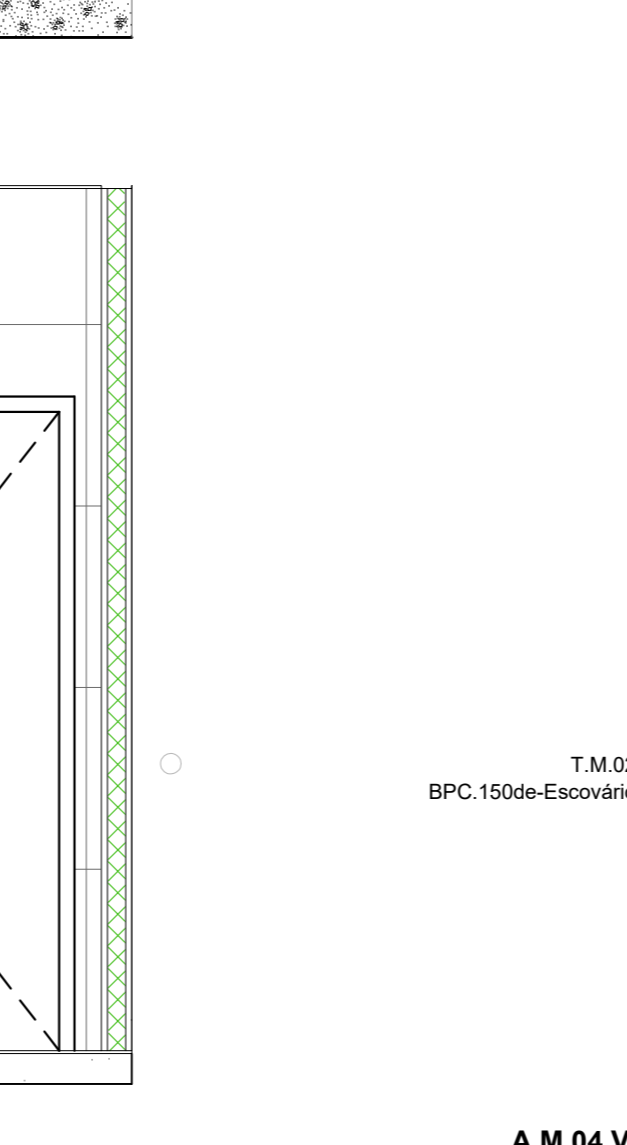

A.M.06 VISTA 2
Escala: 1:25

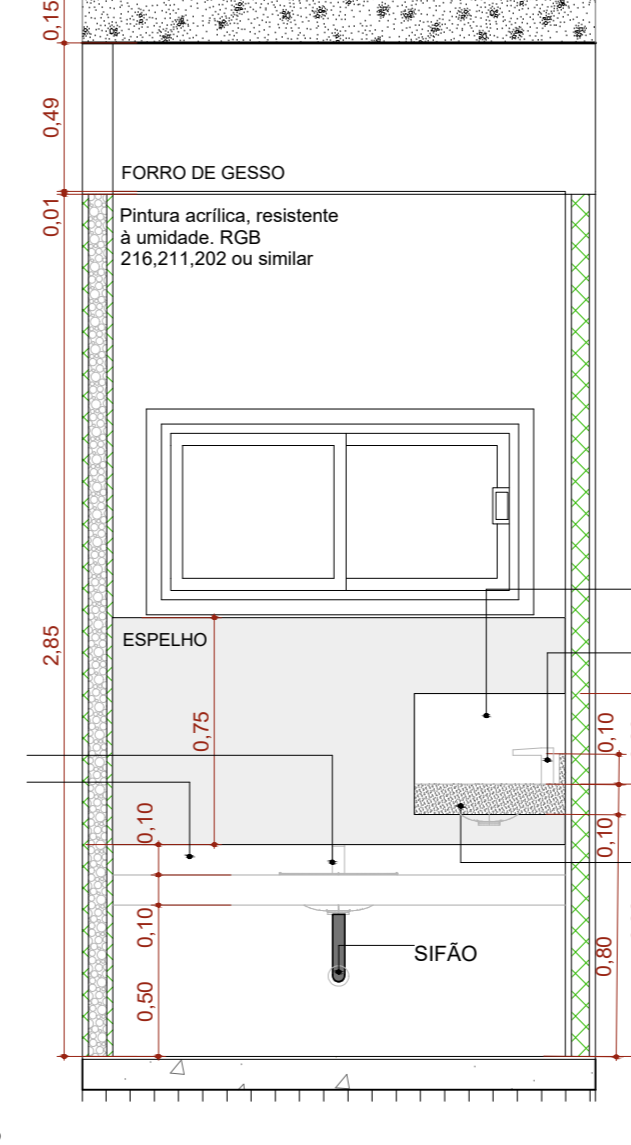

A.M.06 VISTA 3
Escala: 1:25

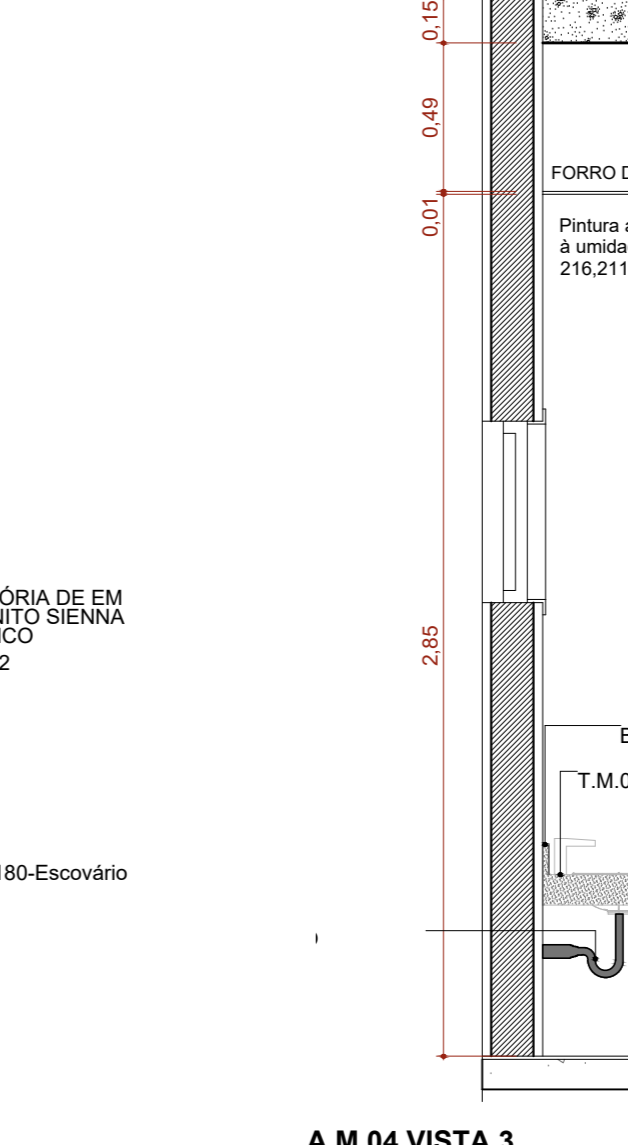

A.M.06 VISTA 4
Escala: 1:25

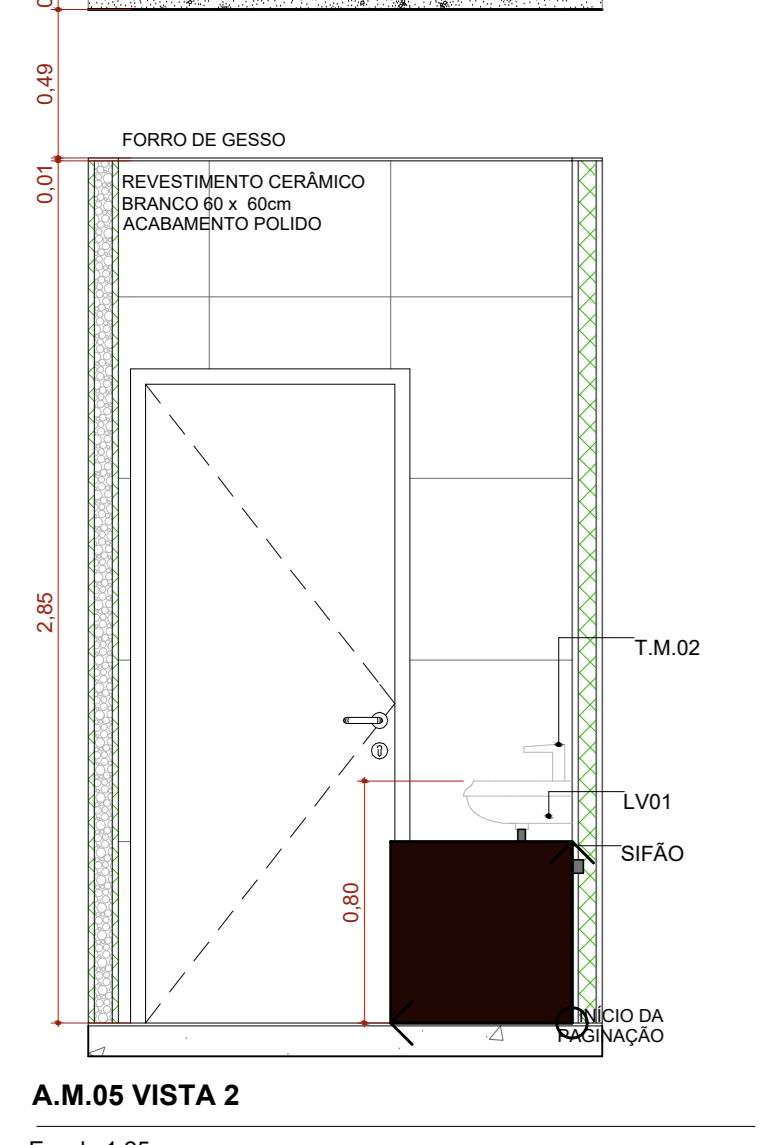

A.M.05 VISTA 2
Escala: 1:25

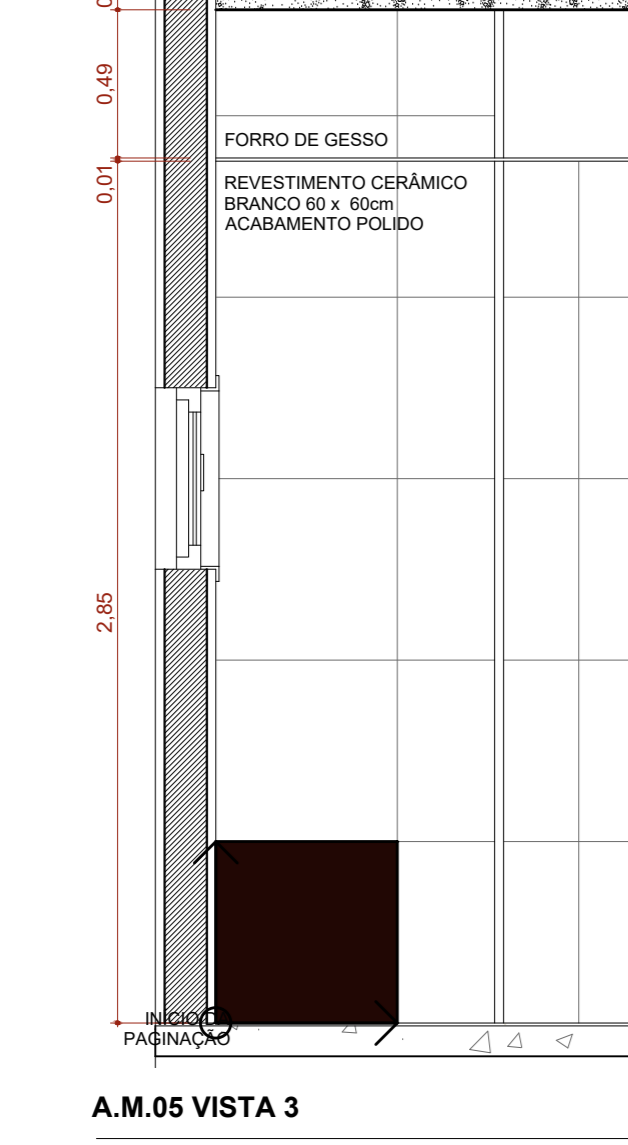

A.M.05 VISTA 3
Escala: 1:25

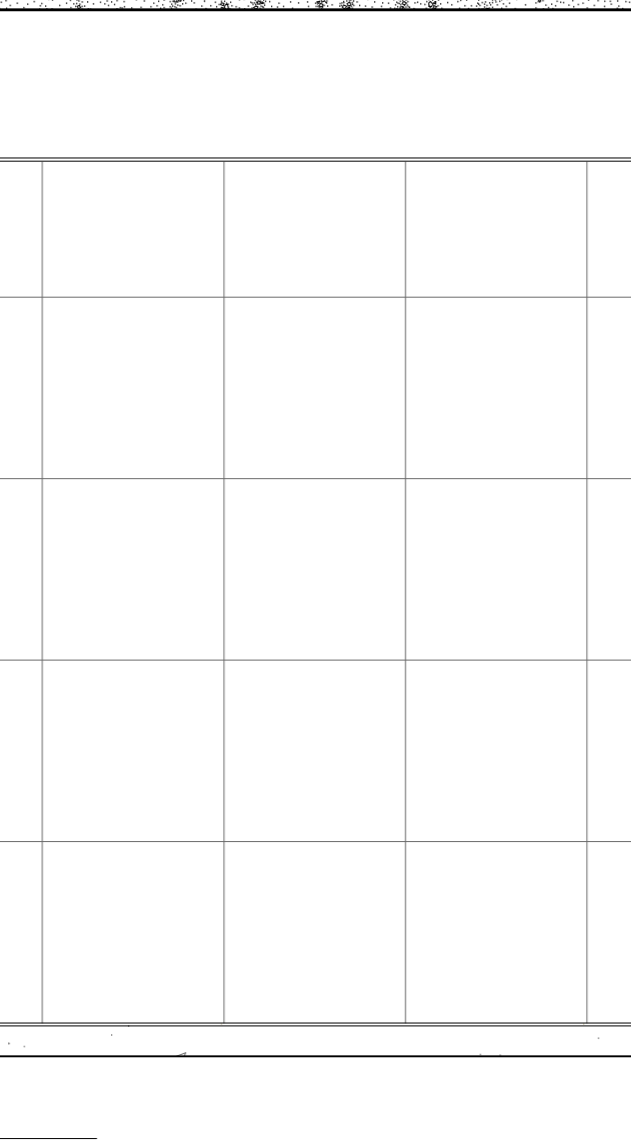

A.M.05 VISTA 4
Escala: 1:25

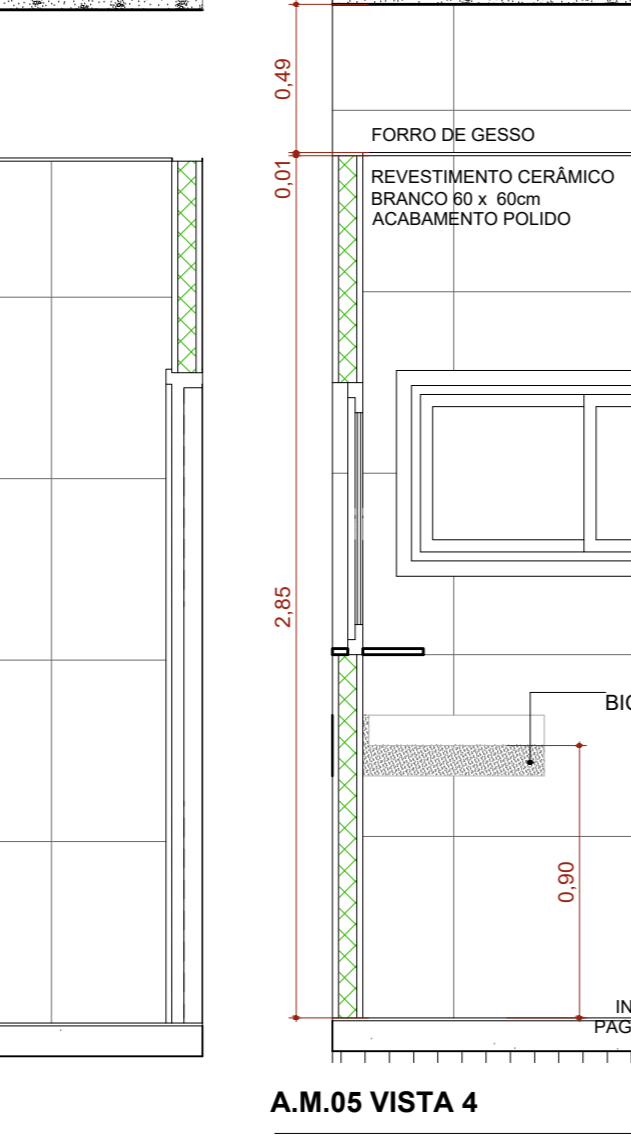

A.M.05 VISTA 1
Escala: 1:25

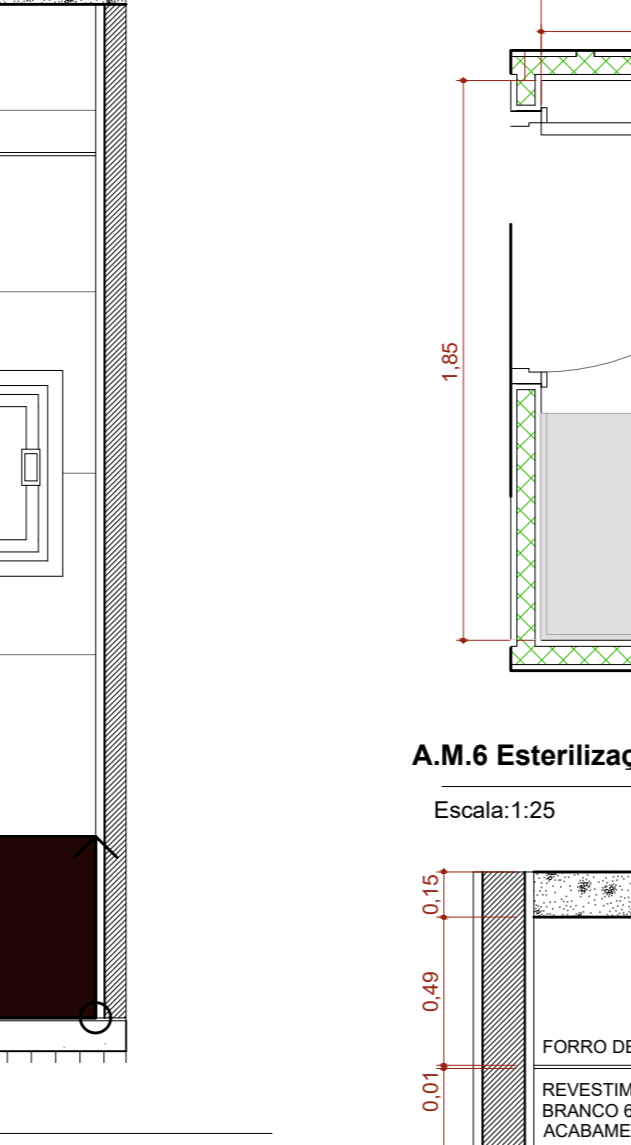

A.M.06 VISTA 1
Escala: 1:25

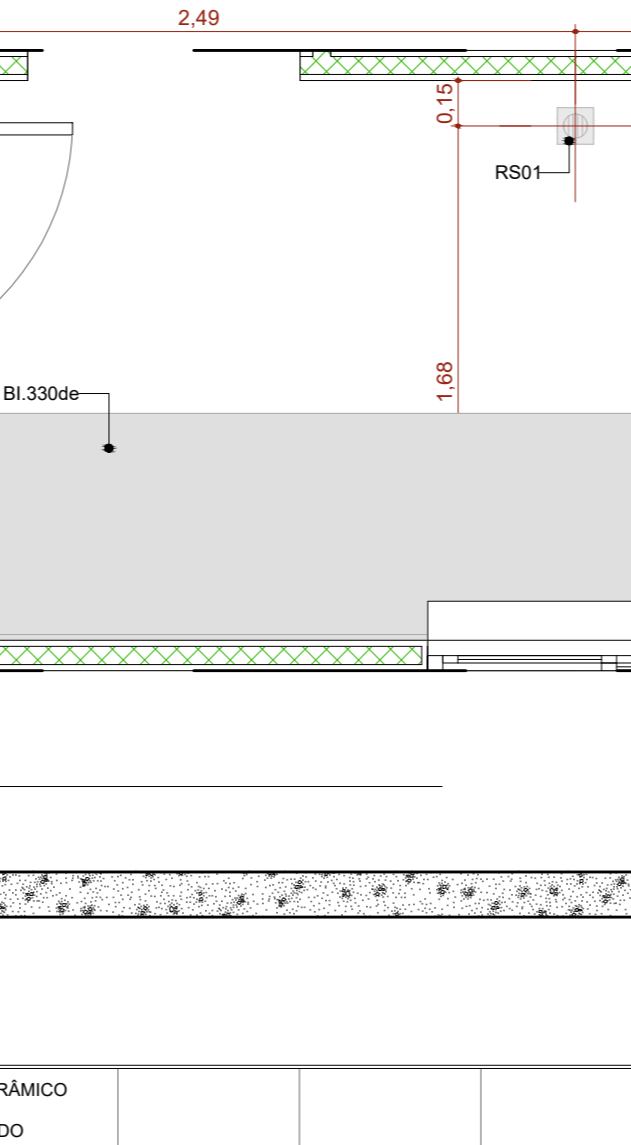

A.M.06 VISTA 2
Escala: 1:25

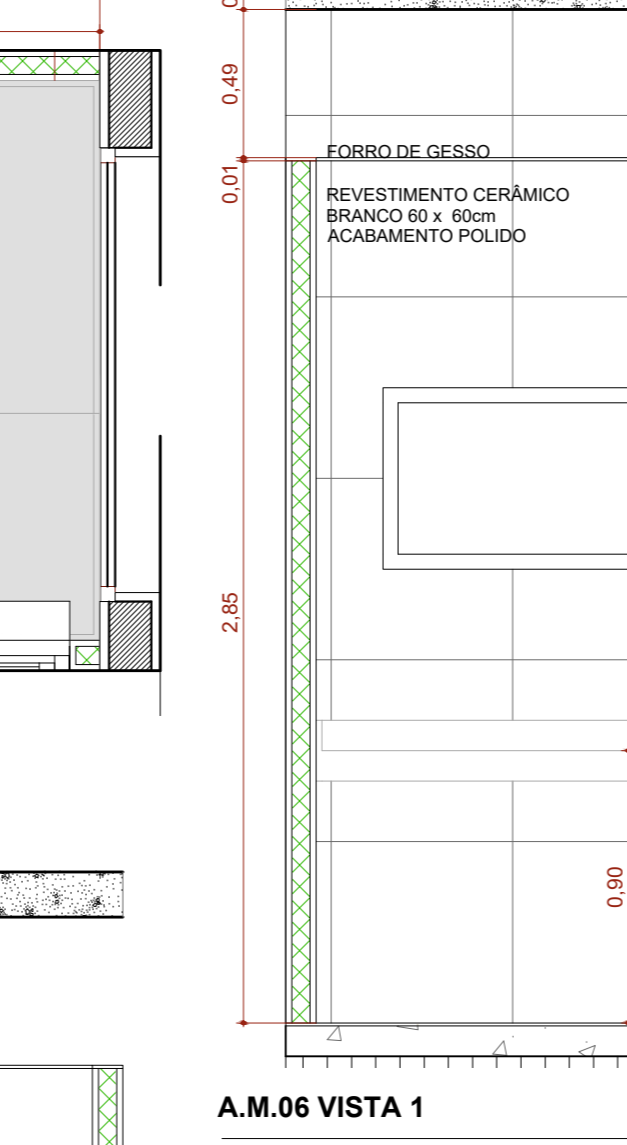

A.M.06 VISTA 3
Escala: 1:25

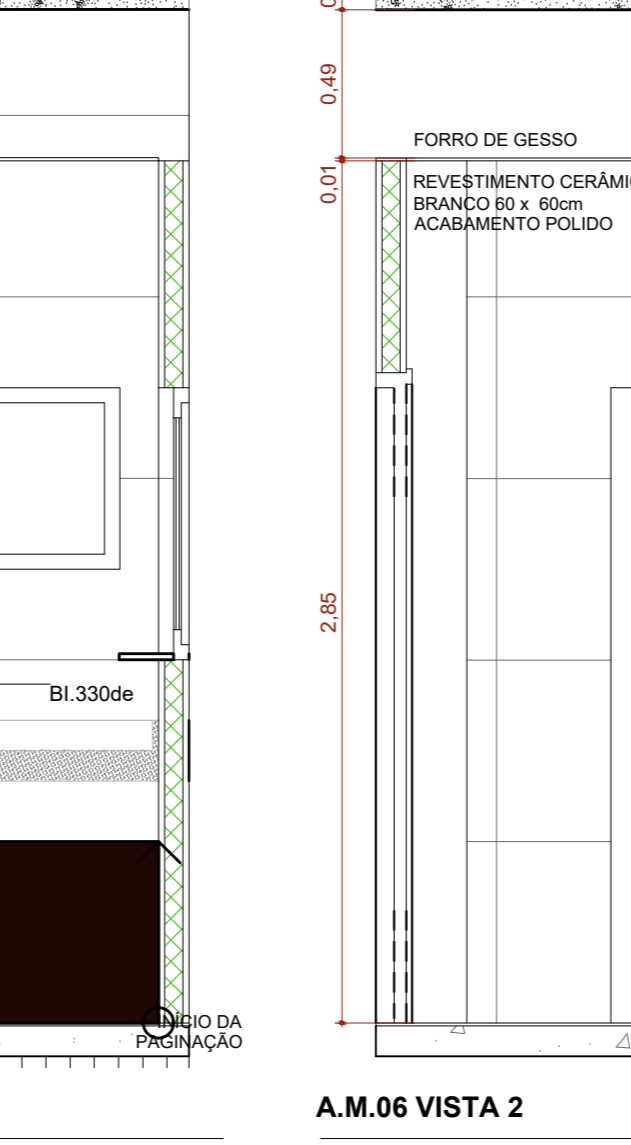

A.M.06 VISTA 4
Escala: 1:25

PLANTA-CHAVE DE SITUAÇÃO				
AUTORA DO PROJETO LICITADO		DATA		REGISTRO
DAFNE CARDOSO TEIXEIRA CREA-MG: 54.248/0		31/12/2025		MG20264657977
TÍTULO DO PROJETO				
UNIDADE BÁSICA DE SAÚDE SANTANA DE MINAS UBS PORTE 1				
PROPRIETÁRIO				
PREFEITURA MUNICIPAL DE SÃO FRANCISCO/MG SECRETARIA MUNICIPAL DE SAÚDE				
CNPJ				
22.679.153/0001-40				
ENDEREÇO				
Secretaria Municipal de Saúde Avenida Brasiliano Braz, Nº.: 515, Centro, São Francisco-MG CEP 39.300-000 - São Francisco - Minas Gerais				
DISCIPLINA				
ARQUITETURA				
PRANCHAS				
11/112				
TÍTULO DA PRANCHAS				
DETALHAMENTO ÁREAS MOLHADAS 01				
DESCRIÇÃO DA ETAPA				
PROJETO EXECUTIVO				
NOME PRANCHAS ARQUIVO	REVISÃO	UNIDADE	DATA	ESCALA
UNIDADE BÁSICA DE SAÚDE SANTANA DE MINAS UBS PORTE 1	R0	METROS	31/12/2025	INDICADA
AUTORIA INTELLECTUAL			REGISTRO	
MIRELA PILON PESSATTI CAU-SP: A 26669-2			ART/RRT: 14590109	
DIREITOS AUTORAIS RESERVADOS CONFORME LEGISLAÇÃO NACIONAL E INTERNACIONAL				FOLHA Nº
				11/20 X 14/16

